

B301C



DEMO PRODUIT



B301C

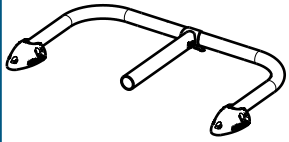

A x1



B x1



C x1



D x2

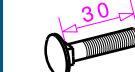

E x3

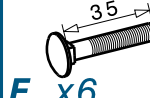

F x6



G x9



H x9



I x9

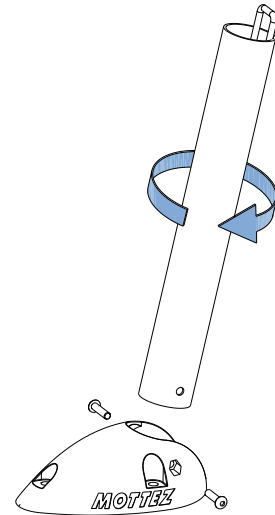
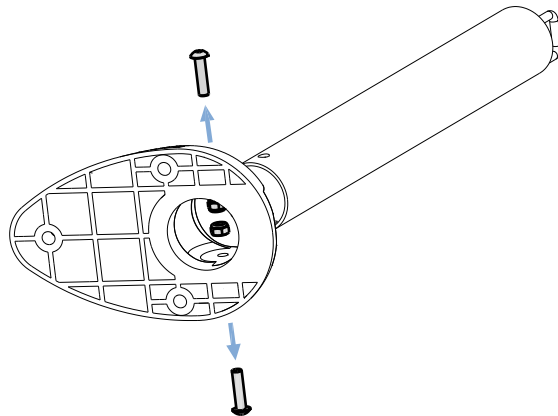
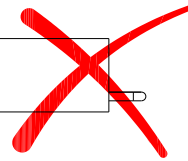
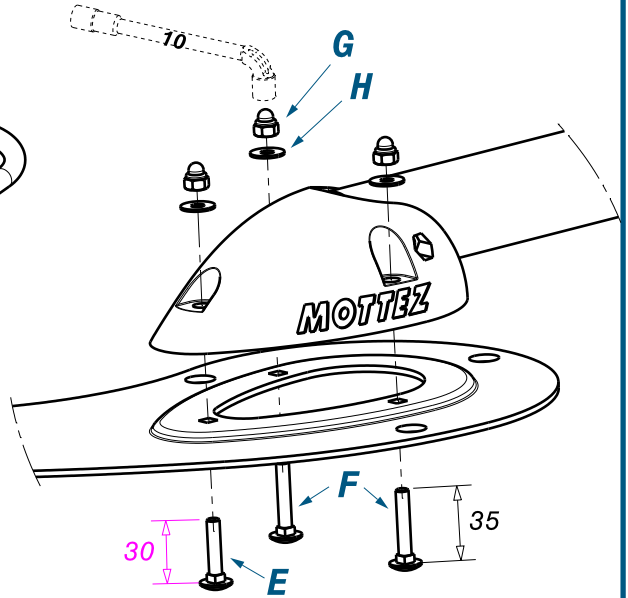
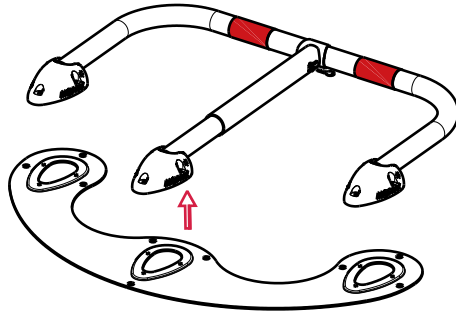
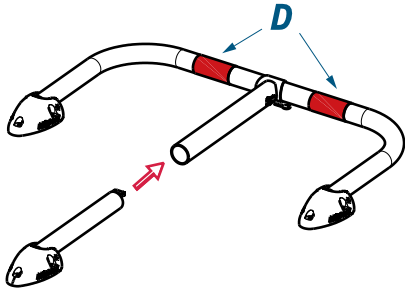

doit être vers le haut



Clouer (sur macadam)
Nail (on tarmac)

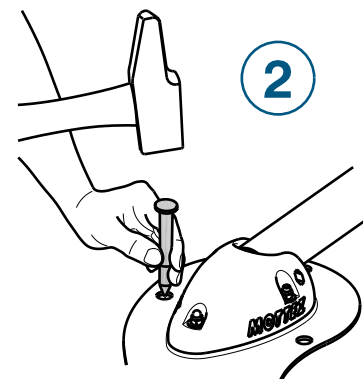
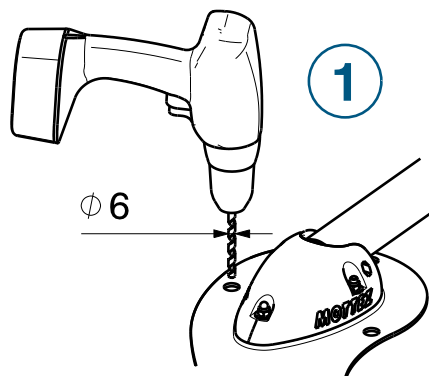
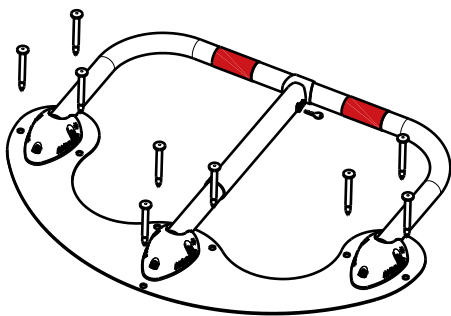

Coller (sur béton)
Glue (on concrete)

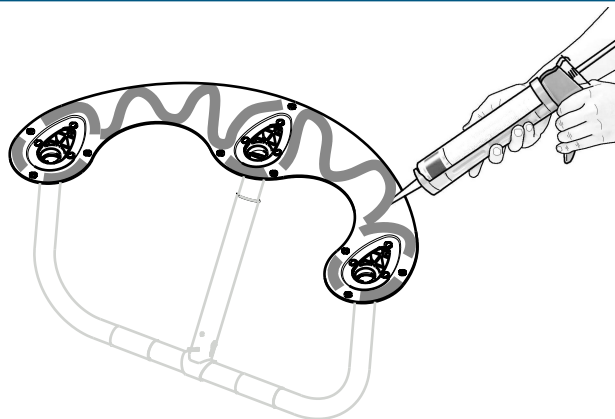
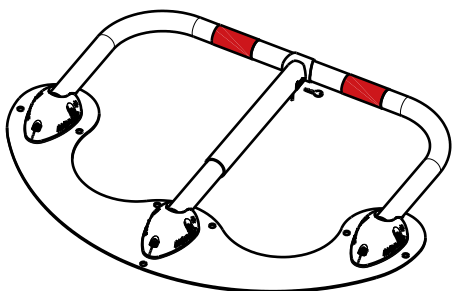

vous pouvez la coller si le support est en béton avec un mastic : colle MS polymère sans solvant
You can glue it with putty if the support is concrete : solvent-free MS polymer glue

